

Tube Fitting Series High Rotary Joint

RHF

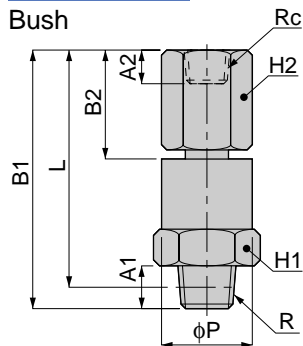

unit:mm

Model	R	Rc	A	B1	B2	L	φP	H1	H2	Mass (g)	Allowable Revolutions (r.p.m)	Idling torque under (g-cm)	Orifice (φmm)	Eff. a. (mm ²)
RHF 01-01	R1/8	Rc1/8	8	47	19	43	16.5	17	14	51	1200	150	5	13.9
RHF 01-02		Rc1/4		51	23	47			17	62				11
RHF 02-01	R1/4	Rc1/8	11	50	19	46	16.5	17	14	56	1200	150	5	14.8
RHF 02-02		Rc1/4		54	23	50			17	68				11.2
RHF 03-03	R3/8	Rc3/8	12	62	26.5	55.5	23.5	24	22	134	900	250	9	47.2
RHF 03-04		Rc1/2		64	28	57			24	140				53.1
RHF 04-03	R1/2	Rc3/8	15	65	26.5	57	23.5	24	22	150	900	250	9	47.5
RHF 04-04		Rc1/2		67	28	58.5			24	160				50.2



unit:inch

MODEL	Tube dia. φ D	NPT	A	B1	B2	L	φ P1	φ P2	φ P3	C	H	Allowable Revolutions	Idling torque under g·cm	Weight (g)	Orifice φ inch	Eff.a. mm ²	Cv
RHC 5/32-U10U	5/32	10-32UNF	0.14	1.69	0.91	1.56	0.43	-	0.47	0.59	1/2	1500	150	24.2	0.07	2.2	0.12
RHC 5/32-N1U	5/32	1/8	0.31	1.89	0.91	1.73	0.43	-	0.47	0.59	1/2	1500	150	29.2	0.12	3.4	0.18
RHC 3/16-N1U	3/16	1/8	0.31	2.15	1.08	1.99	0.51	0.59	0.67	0.65	11/16	1200	150	50.9	0.22	6.6	0.36
RHC 3/16-N2U	3/16	1/4	0.43	2.26	1.08	2.03	0.51	0.59	0.67	0.65	11/16	1200	150	57.4	0.22	6.5	0.35
RHC 1/4-N1U	1/4	1/8	0.31	2.15	1.08	1.99	0.51	0.59	0.67	0.65	11/16	1200	150	50.3	0.22	15.4	0.83
RHC 1/4-N2U	1/4	1/4	0.43	2.26	1.08	2.03	0.51	0.59	0.67	0.65	11/16	1200	150	56.8	0.22	14.9	0.81
RHC 5/16-N1U	5/16	1/8	0.31	2.28	1.18	2.13	0.59	-	0.67	0.69	11/16	1200	150	56.5	0.22	13.6	0.74
RHC 5/16-N2U	5/16	1/4	0.43	2.4	1.18	2.17	0.59	-	0.67	0.69	11/16	1200	150	62.9	0.22	13.7	0.74
RHC 3/8-N3U	3/8	3/8	0.47	2.68	1.24	2.42	0.79	-	0.93	0.79	1	900	250	126.6	0.35	33.0	1.79
RHC 3/8-N4U	3/8	1/2	0.59	2.8	1.24	2.48	0.79	-	0.93	0.79	1	900	250	143.4	0.35	32.9	1.78
RHC 1/2-N3U	1/2	3/8	0.47	2.76	1.4	2.5	0.83	-	0.93	0.91	1	900	250	130.6	0.35	41.9	2.27
RHC 1/2-N4U	1/2	1/2	0.59	2.89	1.4	2.58	0.83	-	0.93	0.91	1	900	250	147.4	0.35	41.4	2.24